

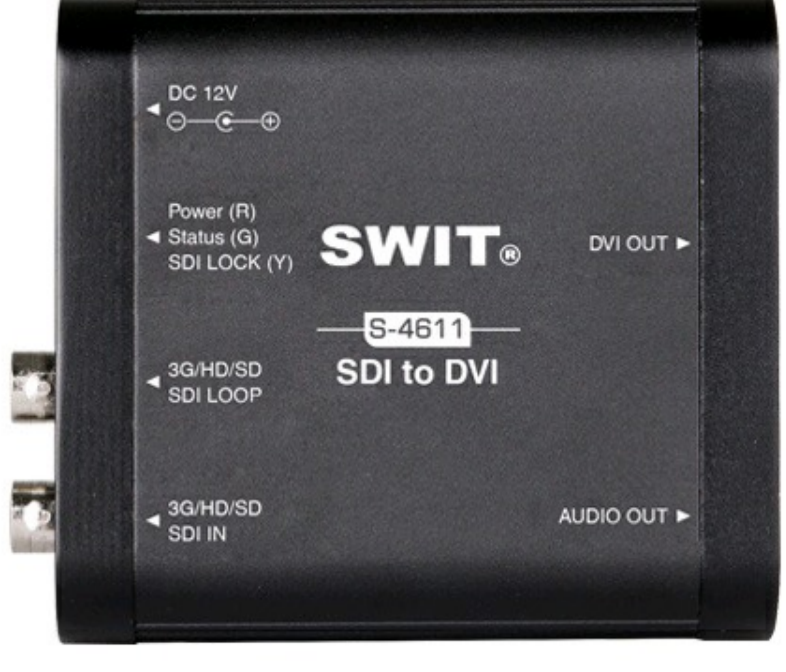

## S-4611 | SDI to DVI Converter



- > Portable 3G/HD/SD-SDI to DVI Converter
- > 1 SDI input, 1 DVI output, and 1 SDI loop
- > SDI audio output via 3.5mm socket
- > Power/input/output status indicator
- > Pole-tap 6-18V DC power input
- > Heavy duty aluminium housing
- > Bottom screw threads for installing



 MSRP Ex TAX / Shipping

[Features](#) [Specifications](#) [Download](#) [What's in box](#) [Optional accessory](#) [Related](#)

### Portable Mini Converter

SDI to DVI, (DVI-D, 18+1)

S-4611 is a mini converter for SDI to DVI conversion, (DVI-D, 18+1 connector), which can be widely used to display up to 3Gb/s broadcast SDI video on DVI monitor, televisions, LED board or projectors.



### Input and Output

- S-4611 offers:
- 1x 3G/HD/SD-SDI input
  - 1x 3G/HD/SD-SDI loop output (Reclocked)
  - 1x DVI-D output
  - 1x 3.5mm audio output (The SDI to DVI supports the same format conversion only.)



### Embedded Audio output

Via 3.5mm socket

The SDI embedded audio ch-1 & ch-2 can be converted to analog audio and output via 3.5mm headphone socket, supports 48kHz sample rate.

### Status Indicators

Power / Input / Output

S-4611 provides 3 LED indicators, to check if the power is connected, and if the input/output signal is delivered.

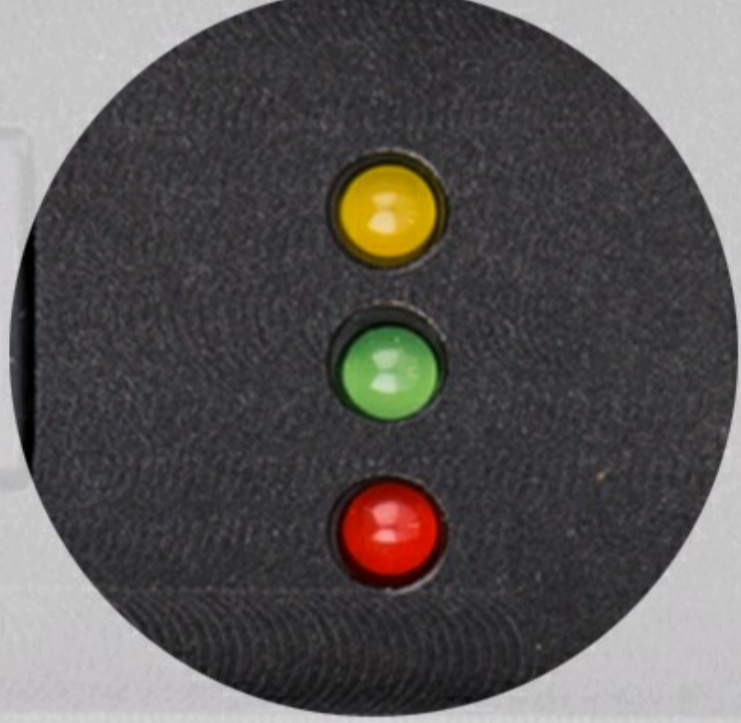

### Power Supply

Pole-tap DC input

The mini converter is powered by pole-tap DC socket. The package includes an AC-DC power adaptor, and you can also connect DC cable from 6-18V batteries.



### Heavy Duty Housing

The S-4611 mini converter adopts unibody aluminium alloy housing, strong for field using and protects the BNC connectors effectively.



### Installation

S-4611 provides the bottom 1/4-inch screw threads for fixing on cameras, and an installing plate is supplied in the package, for fixing on wall and binding the BNC/DVI cables.



### SWIT Electronics Europe GmbH

Heerdterbuschstrasse 10 / HALLE 9,  
41460 Neuss, NRW Germany  
VAT: DE308323924  
WEEE-Reg.-Nr. DE 37399843  
Email: info@swit-europe.com

### Email Newsletter

Please enter Email address below and subscribe our newsletters.

[Privacy Policy](#)

[leave a message](#)

# S-4611

## Portable SDI to DVI converter



### Introduction:

S-4611 is a mini converter for SDI to DVI conversion,(DVI-D, 18+1 connector), which can be widely used to display up to 3Gb/s broadcast SDI video on DVI monitor, televisions, LED board or projectors. S-4611 is heavy duty housing designed, protecting the BNC connectors well, and supplied various screw threads in the bottom, for convenient installation.

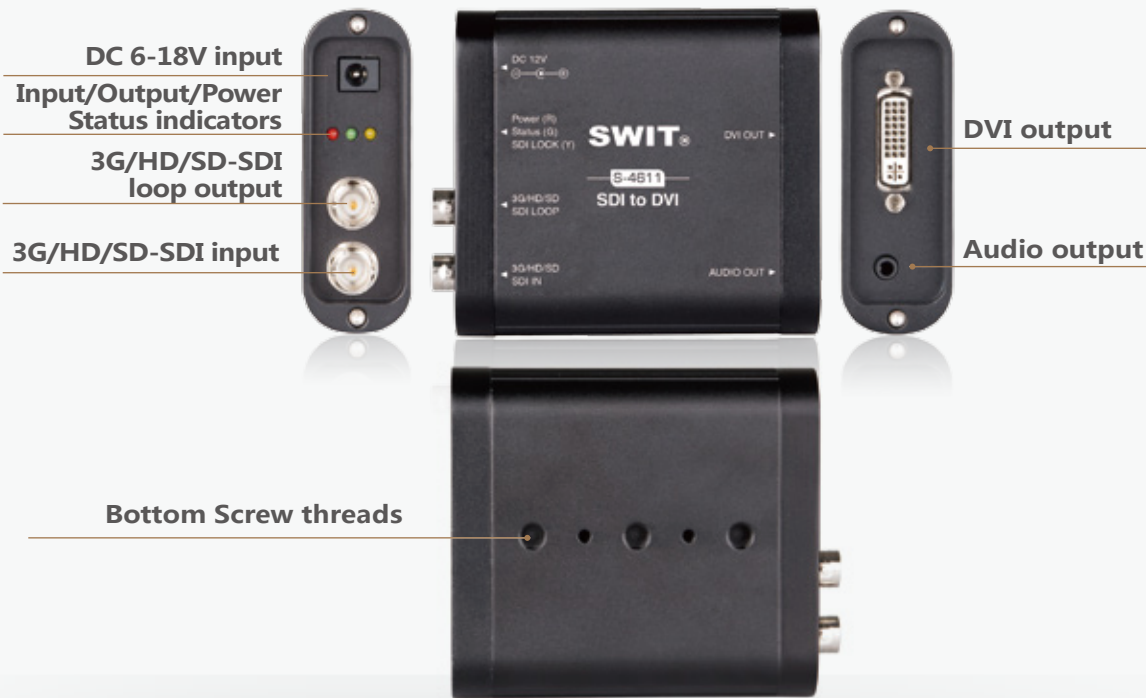

### Specifications:

Input/Output		
Input	BNC × 1	3G/HD/SD-SDI input
Output	BNC × 1	3G/HD/SD-SDI loop output
	DVI-D × 1	Converted DVI output
	3.5mm × 1	SDI audio output
Video Format		
SDI	SMPTE-425M	1080p ( 60 / 59.94 / 50 )
	SMPTE-274M	1080p ( 30 / 29.97 / 25 / 24 / 23.98 )
		1080i ( 60 / 59.94 / 50 )
	SMPTE-RP211	1080psf ( 30 / 29.97 / 25 / 24 / 23.98 )
	SMPTE-296M	720p ( 60 / 59.94 / 50 )
	ITU-R BT.656	576i ( 50 )
DVI	SMPTE-125M	480i ( 59.94 )
	1080p ( 60 / 59.94 / 50 / 30 / 29.97 / 25 / 24 / 23.98 )	1080i ( 60 / 59.94 / 50 )
		720p ( 60 / 59.94 / 50 )
		480i / 576i
Audio	48KHz Sync	
General		
Power	≤3W	
Working Voltage	DC 6-18V	
Working Environment	Temperature: 0°C-+70°C, Humidity:10%-90%	
Dimensions	98 × 84 × 29mm	
Net weight	209g	

### Features:

- ◆ Portable 3G/HD/SD-SDI to DVI Converter
- ◆ 1 SDI input, 1 DVI output, and 1 SDI loop
- ◆ SDI audio output via 3.5mm socket
- ◆ Power/input/output status indicator
- ◆ Pole-tap 6-18V DC power input
- ◆ Heavy duty aluminium housing
- ◆ Bottom screw threads for installing

### SWIT Electronics Co., Ltd.

Website:www.swit.cc  
Email:contact@swit.cc  
Tel:+86 2585805753  
Fax:+86 2585805296

Distributed by:

◀ DC 12V  
⊖ — ⊕

◀ Power(R)  
Status(G)  
SDI LOCK(Y)

**SWIT**®

DVI OUT ▶

**SDI to DVI**  
MODEL:S-4611

◀ 3G/HD/SD  
SDI LOOP

◀ 3G/HD/SD  
SDI IN

AUDIO OUT ▶

SDI IN













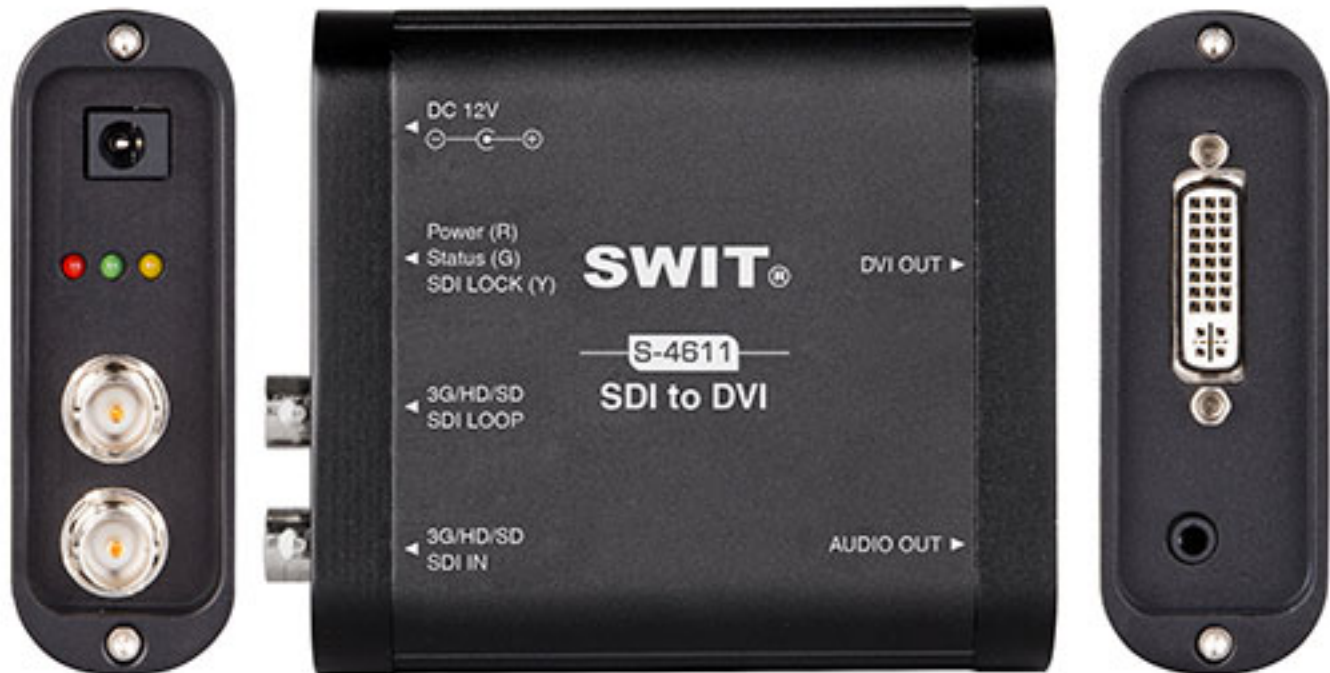



DC 12V



Power (R)

◀ Status (G)  
SDI LOCK (Y)

**SWIT**®

DVI OUT ▶

S-4611

**SDI to DVI**

◀ 3G/HD/SD  
SDI LOOP

◀ 3G/HD/SD  
SDI IN

AUDIO OUT ▶

◀ SDI OUT  
3G/HD/SD

AUDIO IN ▶