

OMNEO

DIGITAL BELTPACK

... THE NEW MULTI-FUNCTION TOOL FROM RTSINTERCOMS

#THERTSDIFFERENCE

BY NICO LEWIS



RTS
DIGITAL BELTPACK



RTS
DIGITAL BELTPACK

EMEA LAUNCH 2020

DIGITAL BELTPACK: TALKING POINTS



DAISY CHAIN

Beltpacks can be daisy-chained
Max 6 daisy chained



Partyline and KP- Mode

Beltpacks can be operated in a Partyline and a keypanel Mode



SUPERIOR SOUND

Audio quality is superior to analog

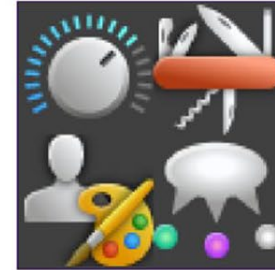

USER-FRIENDLY

Icons make it easy to find what you need



OMNEO ECOSYSTEM

Connect to other OMNEO products

EMEA LAUNCH 2020

DIGITAL BELTPACK: KEY FEATURES

Beltpacks can be **daisy-chained** - Use case is familiar from analog; allows longer chains to be built resulting in improved range and more flexibility when layout out the network.
Max 100m with all cabling.
Max 6 daisy chained. DBP is not acting as a repeater.

Uses Commercial Off The Shelf (COTS)
Power over Ethernet (PoE) switches - Easy to obtain.

Graphical User Interface (GUI)

Full integration into **OMNEO**, Connects to any OMNEO matrix, as well as the OMS Main Station.
Keypanel users can be reached from the beltpack, and vice versa.

Up to **four channels** - OMS supports one, two, or four channels. In the one or two channel modes, the beltpack behaves just like an analog, making it feel more familiar to users.

Bluetooth option for headsets - A Bluetooth option is available. Bluetooth provides some mobility - beltpack becomes a little 'base station' to keep on the desk and move around freely in office.

DBP can be used in Digital partyline and Keypanel **mode** - Can be used connected directly to an intercom Matrix system or an OMS as a digital Partyline



EMEA LAUNCH 2020

DIGITAL BELTPACK: KEY FEATURES

Front view



EMEA LAUNCH 2020

DIGITAL BELTPACK: KEY FEATURES

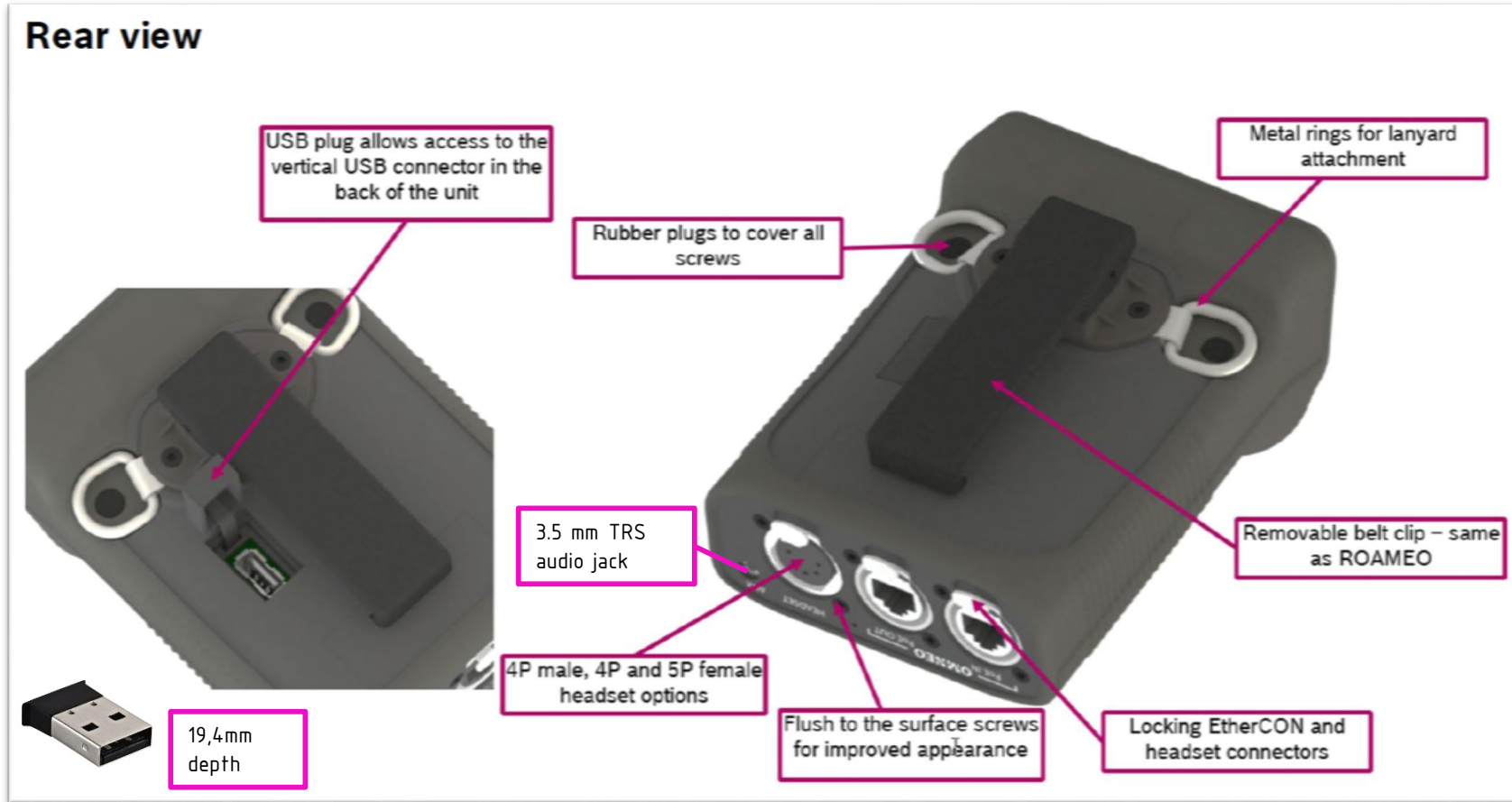

IP 53 rated:

Devices are protected against dust—dust might get inside, but it won't compromise their inner workings—and against spraying water (no pressure) when tilted up to a 60-degree angle.

I suggest to use a dummy plug for connectors that are not used.



EMEA LAUNCH 2020

DIGITAL BELTPACK: UX HOME SCREEN

In bellows figure, please see the UX of the DBP connected to an OMNEO Matrix and in Partyline Mode

► Assignments

- Screen displays assignment name next to each TALK button
- Indication of TALK/LISTEN activation
- Per-conference listen level
- Incoming Call signal indication
- Outgoing Call signal indication

► Status bar icons

- DBP status
- Headset mode
- Bluetooth Aux / Phone
- Aux status
- Vibration
- Bluetooth headset
- Mic status
- CWW indication

► Pop-up windows (only on activity change)

- Master volume adjust
- CWW



The DBP in KEYPANEL mode is only possible when its Connected with the OMI and ODIN Matrix. Not when its connected with The OMS!

The DBP in PARTYLINE (PL) mode is possible when its connected with the OMS.

EMEA LAUNCH 2020

DIGITAL BELTPACK: UX STATUS BAR

- Provides real time status of key DBP functions:
 - MIC status (normal / hot mic / MUTED)
 - Headset status: Indicates active headset (XLR / 3.5 mm Aux / BT)
 - DBP Status
 - Aux Status
 - Call Waiting Status
 - Haptic Vibration enabled
 - Bluetooth headset status (dongle installed / pairing status / connected)
 - Bluetooth Aux / phone status (dongle installed / pairing status / connected) phone is linked to headset and not forwarded to central system
- Not shown while in MENUs

TALK active indicator for conference





View of keypanel mode



View of PL mode



EMEA LAUNCH 2020

DIGITAL BELTPACK: KEY FEATURES & VALUE ADD

- Higher Audio Quality including increased fidelity and lower noise floor
- Stereo audio capability (supports different feeds on LEFT & RIGHT headphone)
- Access to a greater 'pool' of party lines (16 versus 2)
- Support for a higher number of simultaneously active party lines / conferences (4 vs 2)
- Ability to connect a belt pack directly to an OMNEO capable matrix without a Main or Master Station
- Bluetooth Headset support
- Ability to daisy chain digital belt packs through PoE
- 3.5 mm TRS audio jack
- Haptic (vibration) feedback for CALL and other alerts
- Ease of configuration and upgrade through the OMS
- Icon-based set-up & configuration on DBP menus
- Ability to assign 1 or more of the 4 conference TALK keys to a relay control function

EMEA LAUNCH 2020

DIGITAL BELTPACK: LIMITATIONS

With only 1 IP address, DBP will not be able to connect to more than one OMS or OMNEO based matrix. Can still connect to a 2nd Dante device. *There is no control information or audio flow control for the 2nd OMNEO port on the DBP.* The 2nd OMNEO port will act like AUX audio.

- DBP will not support peer-to-peer operation (stand-alone operation use case)
- DBP will not support any RVON connectivity
- DBP will not incorporate fiber support (inconsistent with PoE power recovery)
- Haptic feedback will have options of Pulsed Enabled or Disabled. It will not have programmable pulse cadences.
- DBP will only support standard latency (SBC) Bluetooth operation. No support for low latency Bluetooth codec (APT-X-LL).
- Top Display GUI will not 'flip' as DBP is physically rotated (will not act like Smart Phone). There will be a menu option to flip the display orientation manually if desired.
- Since DBP has no 'earth ground' potential, external connectors (including headset) will be left floating.
- DBP will NOT incorporate a PoE PSE device which supports 802.3bt (802.3af and 802.3at only) 802.3af (PoE) can deliver 15.4 watts over Cat5.

EMEA LAUNCH 2020

DIGITAL BELTPACK: ORDER INFORMATION

F01U.363.442 DBP	4M Digital Partyline IP 4 ch wired beltpack 4M headset	804 EUR
F01U.363.443 DBP	4F Digital Partyline IP 4 ch wired beltpack 4F headset	804 EUR
F01U.363.444 DBP	5F Digital Partyline IP 4 ch wired beltpack 5F headset	804 EUR

EMEA LAUNCH 2020

OMS & DBP: VERTICAL FOCUS



Broadcast Fixed Install

► **OMNEO Main Station:**

Configurable digital Master Station that can be deployed geographically within a broadcast campus.

► **Digital Beltpack:**

Easy and cost effective keypanel deployment in existing RTS installation. Perfect fit for basic operators such as lighting operators



Outside Broadcast

► **OMNEO Main Station:**

Perfect for DSNB trucks for basic coms system. Supports digital wired and wireless systems (DBP & ROAMEO) + keypanel support (4 or 8), perfect for fixed positions with smaller OB vehicles RVON capability

► **Digital Beltpack:**

Wired digital partyline – premium sound quality – dual mode operation – enables ad hoc keypanels to be created on special events – designed for field use, rugged – fast setup and use



Theater/ Cruise Ship

► **OMNEO Main Station:**

Intelligent Master Station for wired & wireless coms w/o complexity of a matrix. Benefits of IP – BP and Keypanel deployment – less wiring and lower installation costs – Dante compatible – scalable – Ease of use – low learning curve

► **Digital Beltpack:**

Rugged design – trusted technology. Excellent sound quality – 7.5Khz frequency response – versatile & multi mode operation (PL & KP mode) – daisy chain option – extreme lightweight



Rental

► **OMNEO Main Station:**

Perfect for small broadcast events – no large matrix required. Similar to traditional base station system approach. Pre-packed systems approach – flight packs. Aggressive price point makes ROI proposition strong (f.e CC Helixnet).

► **Digital Beltpack:**

Large native OMNEO market. Designed for indoor and outdoor – attractive price point compared to competition – versatile usage (PL or keypanel)



Live AV/ Entertainment

► **OMNEO Main Station:**

Simple, flexible – no need for a matrix. 1 RU for PL and wireless incl. keypanel support for larger events. Interoperability via Dante (FOH console) – low power consumption – easy to maintain. Digital audio quality. Integration with third party radios is prepared

► **Digital Beltpack:**

Easy to use for semi skilled operators – daisy chain option for fast rigging – weather proof for outdoor use – light weight



Industrial

► **OMNEO Main Station:**

Simple yet versatile solution for non skilled operators. Multiple OMS's can be installed geographically around a site enabling operators to communicate across all sites. Can use standard network equipment – low cost of installation – multi format

► **Digital Beltpack:**

Easy to use for low skilled operators – uncluttered UX – Can be used anywhere where there is network access, useful in sights with restricted RF but need for good audio quality.

EMEA LAUNCH 2020

USE CASE

THEATER

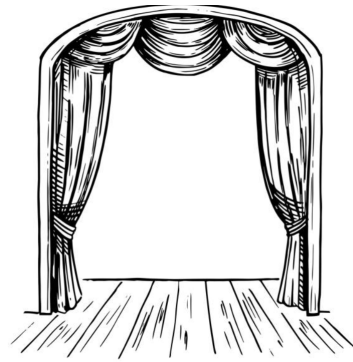

Distributed OMS Advanced (2) within 2 theatres (either within a campus or a large cruise liner).

FOH Mixing console talkback integration via 4W (but can be OMNEO if console is DANTE enabled) back to OMS.

Digital Partyline is shown as 15 x DBP's via OMNEO to PoE switches combined with 2W (PS20 & 2 x BP4000).

ROAMEO is supported by OMNEO to support 12x TR1800 and 4x AP1800's.

Keypanels for LD, Sound, Director through 8 x KP4016, 4 panels via 4W and 4 panels via OMNEO.

Importantly the Stage Announce facility is shown via program output from OMS feeding a mic preamp/ microphone system. This feeds a separate amplifier and speaker to complete the stage announce circuit.

This example supports a high number of operators for larger & more complex productions.

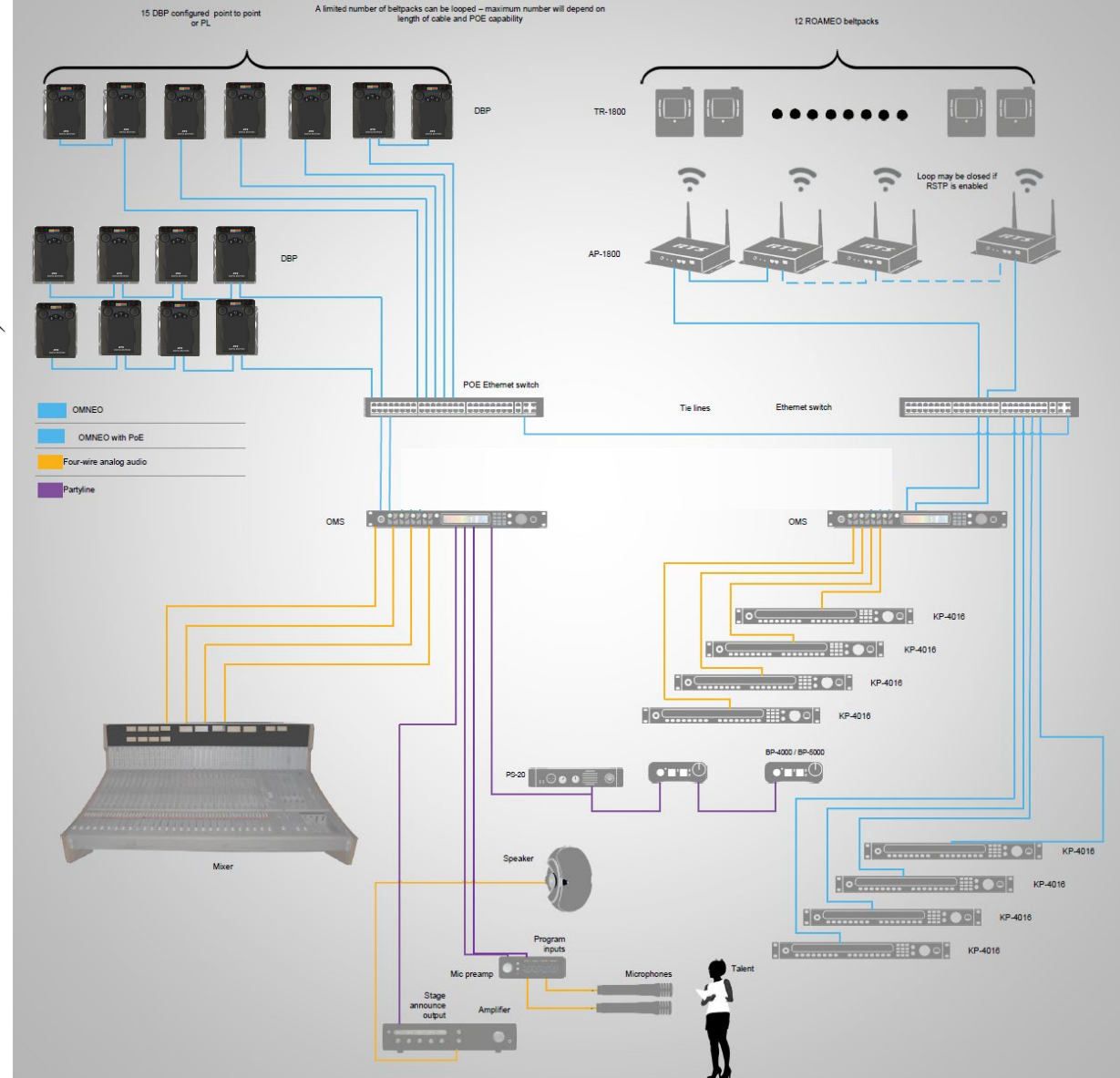

EMEA LAUNCH 2020

USE CASE

BROADCAST FIX



2 x OMS Advanced to show Comms being distributed between 2 studios.

Mixing console talkback integration via 4W (but can be OMNEO if console is DANTE enabled)

OMS 1 is providing OMNEO feeds to DBP's via PoE switches, and is also supporting 2W analogue (allows legacy equipment to be also used, in this case PS20 & BP4000)

OMS 2 is linked by OMNEO to OMS1, and is providing OMNEO to ROAMEO DECT as site wireless OMS 2 is supporting 4 x KP4016 by 4W, and an additional 4 x KP4016 by OMNEO

Exhibit the versatility of OMS & DBP in a live entertainment show environment.

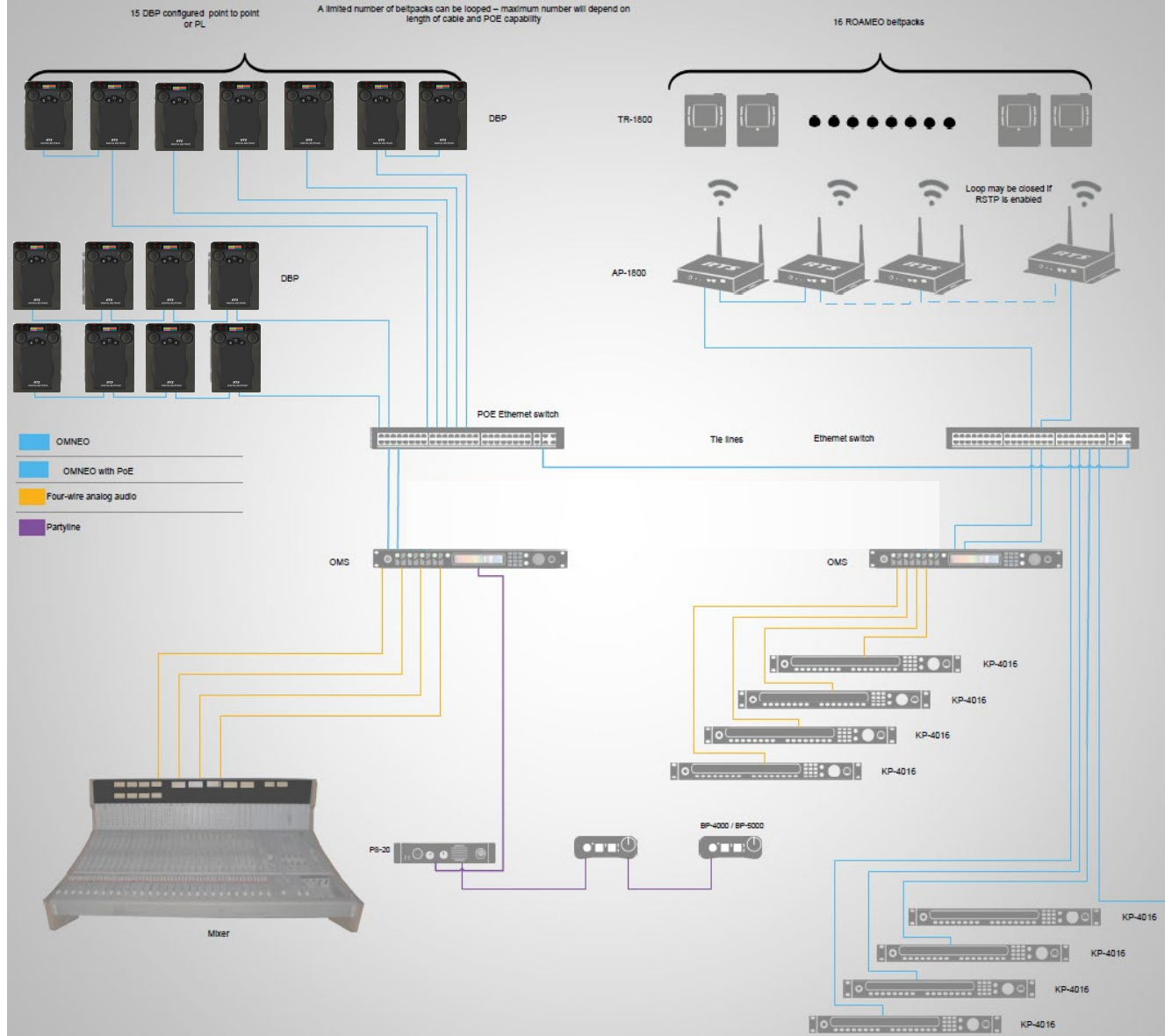

EMEA LAUNCH 2020

USE CASE

DSNG TRUCK

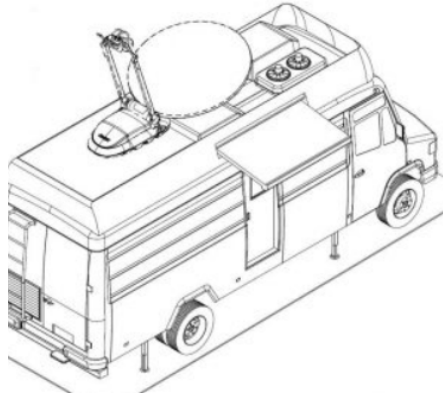

OMS offering a cost effective powerful solution for a small DSNG vehicle

Limited requirement for keypanels make this ideal for OMS.

- 3 x KP4016 connected by 4W and 1 x RVON
- Digital Party Line is supported by OMNEO to PoE switches (7 x DBP for camera operators)
- 2W legacy equipment can be supported via PS20 & BP4000
- Wireless is supported via ROAMEO (2 x AP1800, 4 x TR1800)
- BTR UHF can also be used by either 4W or 2W

OMS Advanced ability to provide RVON. RVON feeds to the onboard satellite uplink.

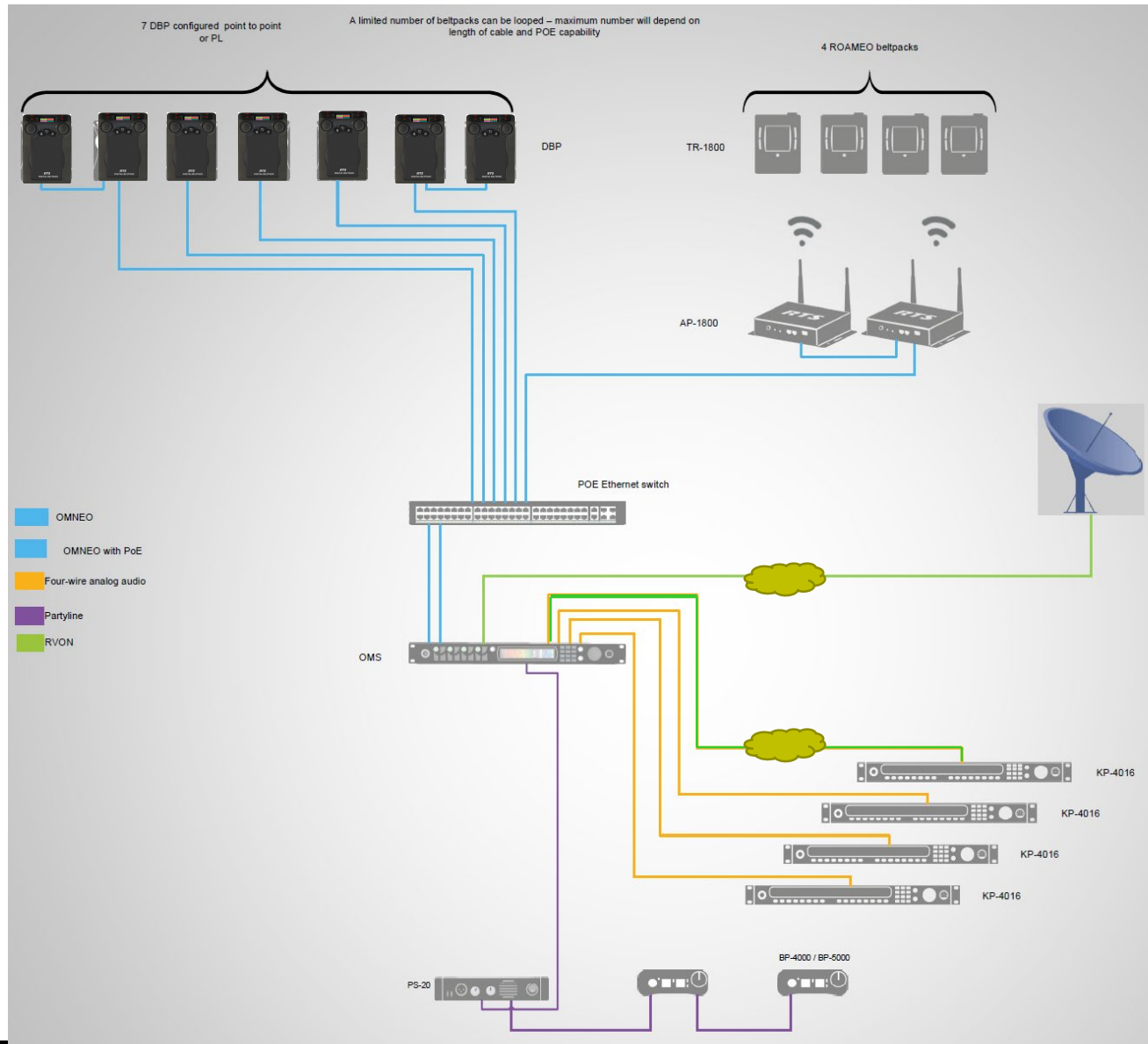

EMEA LAUNCH 2020

USE CASE

INDUSTRIAL

(NUCLEAR POWER STATION)



- OMS 1 (Advanced) is providing OMNEO to 15 x DBP via PoE switches as digital partyline.
- 2w is supported via PS20 and BP400 - combined analogue and digital partyline circuits.
- UHF is a base requirement within power stations for range & reliability - OMS1 providing 4W circuits to BTR800 base stations combined with 8 x TR800 for wireless comms.
- OMS2 is providing OMNEO lines to ROAMEO DECT wireless - 16 x TR1800 & 4 x AP1800 for mobile operators.
- Keypanels for key operators are supported by 8 x KP4016, 4 panels via 4W and 4 panels via OMNEO

Multiple formats and distributed audio within a challenging environment in a simple intelligent system.

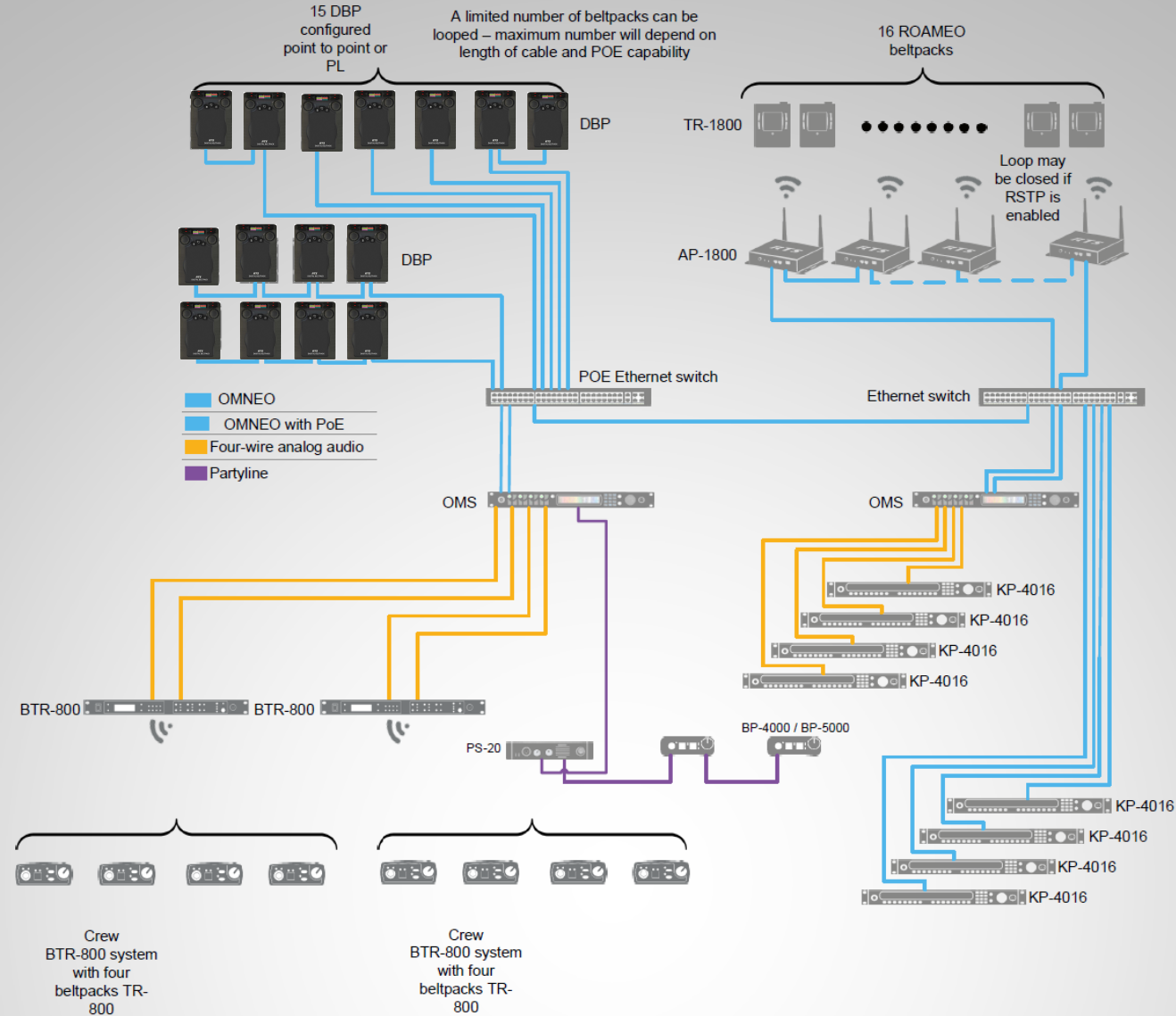

LIVE AV/ ENTERTAINMENT



FOH Mixing console talkback integration via 4W (but can be OMNEO if console is DANTE enabled) and Monitor console (via OMNEO) enables complete communications between consoles and partyline channels.

Digital partyline (11 x DBP's) are via OMNEO to PoE switches, and legacy 2W is also shown as PS20 & 2 x BP4000, so combined analogue and digital partyline circuits.

Wireless communication is supported via OMNEO to 2 x AP1800 and 4 x TR1800's.

Basic keypanel requirement shown as 2 x KP4016 connected via OMNEO.

Importantly the Stage Announce facility is shown via program output from OMS feeding a mic preamp/ microphone system.
This feeds a separate amplifier and speaker to complete the stage announce circuit.

Touring & live events communications in digital & analogue formats fully supported from a 1U device, OMS !

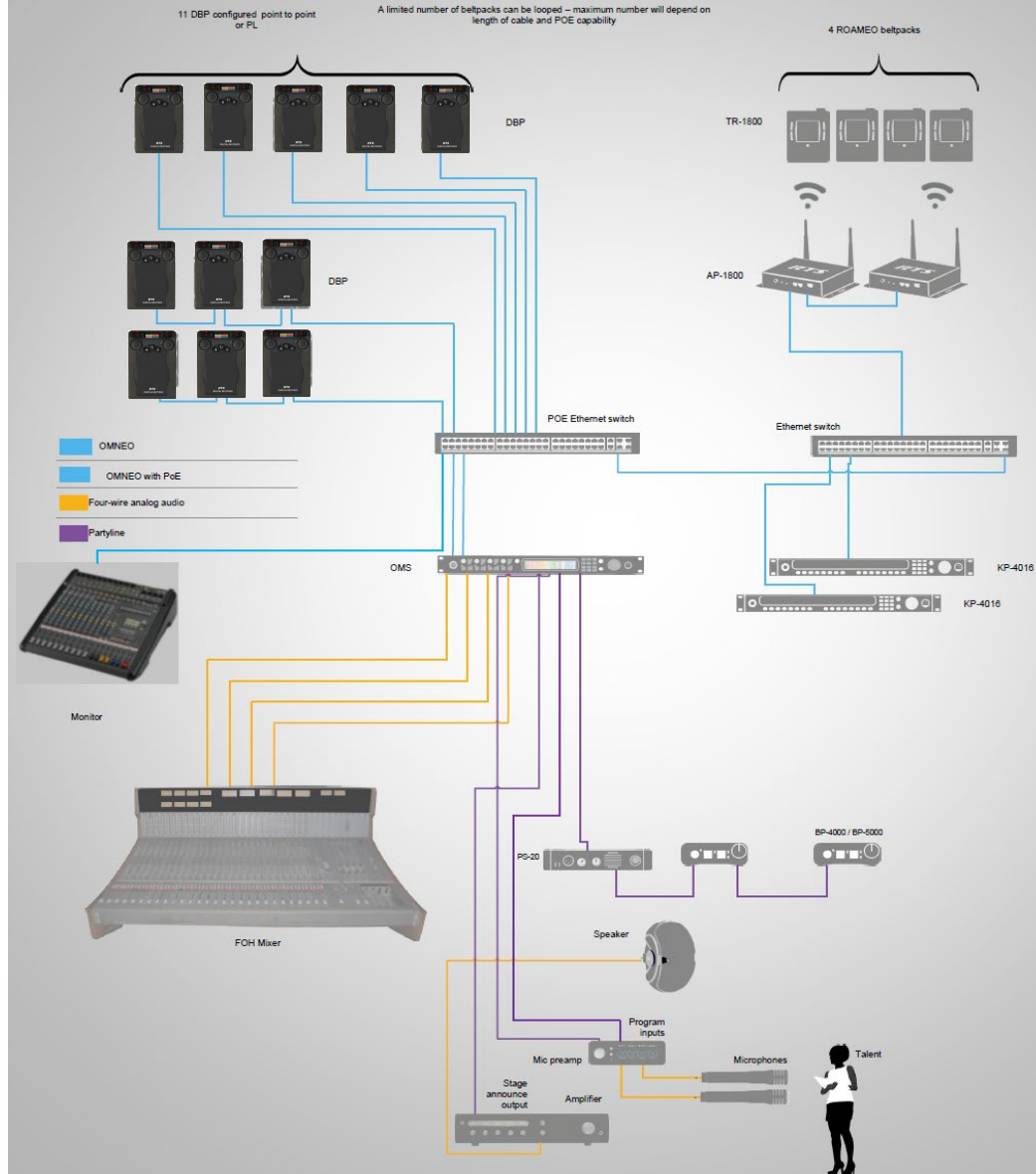

Prepare your presentations but wait before you put
it online.



THANK YOU